

WHO WE ARE

With over 25 years of professional expertise, we are committed to delivering complete washroom equipment solutions featuring innovative design, superior performance and reliable quality, serving customers worldwide.

Our Mission:

Committed to supplying hygienic, comfortable and elegant washroom solutions for all world.

Our Vision:

To be the pioneer and leader in commercial washroom equipment.

Our Values:

With the philosophy of Customer Oriented, create value for global customers;

Adhere to mutual benefit and win-win cooperation;

Improve everything we do continuously, keep moving forward;

Insist on teamwork and team development;

Shoulder social responsibilities, do the right thing;

Embrace changes, arm ourselves with science and technology.

HOTEC

WHAT WE OFFER

As one of the leading washroom equipment suppliers in China, Hotec is committed to providing hygienic, comfortable, and elegant solutions to public washrooms.

To this end, we have developed over 300 products of good design, premium quality, and high value to meet the expectations of our customers.

RESTROOM EQUIPMENTS



HAND DRYERS
TAMPONS & PADS DISPENSERS
AUTOMATIC FAUCETS
SOAP DISPENSERS
PAPER TOWEL DISPENSERS
GRAB BARS
BABY CHANGING STATIONS
URINAL SCREENS
URINAL MATS

TOILET ACCESSORIES



JUMBO PAPER DISPENSERS
TOILET TISSUE DISPENSERS
TOILET BRUSH HOLDER
ACCESSORIES

BATHROOM ACCESSORIES



SHOWER SEATS
SHAMPOO & BODY DISPENSERS
HAIR DRYERS



WHAT WE DO

At Hotec, we don't just supply products, we deliver complete washroom solutions tailored to your specific needs.

Our global customer-centric approach includes:



Customized Solutions

From design consultation to product modification, we work closely with you to develop bespoke solutions that align with your brand identity, space requirements, and budget constraints.



Reliable Supply Chain

With our state-of-the-art manufacturing facilities and efficient logistics network, we ensure timely delivery and consistent quality across all your orders, no matter the size.



End-to-End Support

Our dedicated team provides seamless service throughout the entire partnership. From pre-sales technical advice and product training to after-sales maintenance and warranty support, we are committed to your success.



Long-Term Partnership

We believe in building sustainable, win-win relationships. Our flexible business models, competitive pricing, and commitment to mutual growth make us your ideal long-term partner in the commercial washroom industry.

With over 25 years of profound experience shaping the industry, we have built a comprehensive industrial chain spanning R&D, design, manufacturing, quality control, and global marketing—enabling us to deliver reliable, high-performance washroom solutions to collective clients across worldwide.

We offer versatile washroom solutions suitable for a full range of public and commercial scenarios.



Airport & subway



Shopping mall



Hospital



Restaurant



Health & Wellness centres



Office

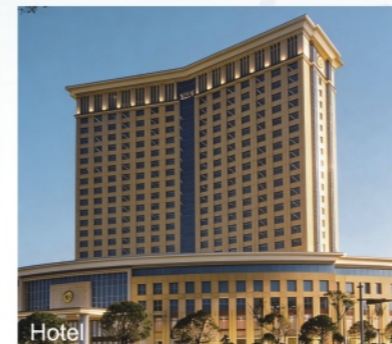

Hotel



School & Colleges



Factory

TOILET ACCESSORIES



16.653
Sanitary bag dispenser
 material: ABS
 capacity: 25pcs
 colour: white



14.122
 material: 304 stainless steel
 dimension: 420x300x50mm



16.626mb
 material: 304 stainless steel
 dimension: 270x105x105mm



17.501 Sanitary bin
 capacity: 4L
 material: 304 stainless steel
 dimension: 260x190x90mm



16.621a
 material: 304 stainless steel
 dimension: 132x85x65mm



16.643
 material: 304 stainless steel
 dimension: 183x92x100mm



16.624a
 material: stainless steel
 dimension: 125x125x120mm



16.627b
 material: 304 stainless steel
 dimension: 158x298x68mm

TOILET ACCESSORIES

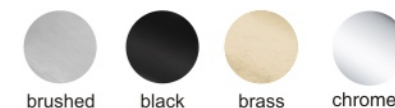

material: 304 stainless steel



16.107



16.207



16.307



16.101



16.201



16.301



16.S119

material: Zinc



16.507



16.507-2



16.Z107



16.501



16.519

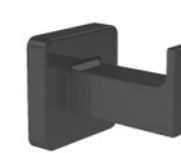

16.Z101



16.Z109

TOILET ACCESSORIES



16.601
material:
stainless steel
dimension:
Φ 89 x H(250-400)mm



16.602
material:
stainless steel
dimension:
103x H(248-378)mm



16.604
material:
stainless steel
dimension:
103xW85xH390mm



16.603
material:
stainless steel
dimension:
100x W(78-110)x H375mm



16.6011
material:
304 stainless steel
dimension:
89x123xH(150-400)mm

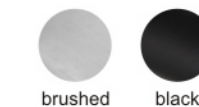

brushed black



16.6010
material:
304 stainless steel
dimension:
(90-123)x90xH(150-395)mm



16.606
material:
stainless steel
dimension:
Φ (76-100) x H350mm



16.607
material:
stainless steel
dimension:
Φ 140xH375mm



16.608
material:
stainless steel
dimension:
93x93xH(250-375)mm



16.611
material:
polypropylene
dimension:
130xH380 mm



16.615
material:
polypropylene
dimension:
(105-145) xH390 mm



16.616
material:
polypropylene
dimension:
L95 x W105 x H425mm

The mountain stands there,
Reaching high into the clouds.
The water is at his feet,
Rippling with the wind,
As if pleading with him,
Yet he remains proudly still.

— West Lake Impromptu
Rabindranath Tagore, *Written in 1924, Hangzhou, China*

HOTEC

Email: hotec@cncotec.com

<https://www.cncotec.com/>



website



whatsapp

*All product sizes and colours prevail in kind, subject to change without notice.